

THE COUNCIL OF THE CITY AND COUNTY OF SWANSEA
CYNGOR DINAS A SIR ABERTAWE
TEMPORARY ROAD CLOSURE
THISTLEBOON ROAD, MUMBLES, SWANSEA.
NOTICE 2025

NOTICE is hereby given by the Council of the City and County of Swansea in pursuance of its powers as contained in section 14 (2) of the Road Traffic Regulation Act 1984 (as amended) that from **Friday 28th March 2025** for a period of 21 days only (or until the works are completed whichever is sooner – it is anticipated that the work will take 21 days to complete), no person shall cause any vehicle to be driven as referred to in the schedule below. In order for Wales & West Utilities to carry out remedial leakage works at the above location; it has been necessary to temporarily close the above road to vehicular traffic. The effect of this Notice is to extend the existing Notice dated the 7th March 2025 that otherwise would have ended on the 27th March 2025.

SCHEDULE

SCHEDULE 1- TEMPORARY ROAD CLOSURE
THISTLEBOON ROAD, MUMBLES

Thistleboon Road in a south-easterly direction from its junction with Tichbourne Street to its junction with Higher Lane/New Villas, a distance of approximately 140 metres.

The alternative route for vehicular traffic will be via the unaffected length of Higher Lane/New Villas, Plunch Lane, Mumbles Road and Western Lane, a distance of approximately 3 kilometres.

SCHEDULE 2 - TEMPORARY REVOCATION OF NO ENTRY
THISTLEBOON ROAD, MUMBLES, SWANSEA

Thistleboon Road from its junction with Higher Lane/New Villas.

Access for emergency vehicles, pedestrians and residents to be maintained at all times.

The applicant will be responsible for the erection and maintenance of all advanced warning, Road Closed, diversion and alternative route signs in accordance with Chapter 8 of the Traffic Signs Manual and the Traffic Signs and Regulations and General Directions 2016 for the duration of the works.

Dated this 27th March 2025

D.J. SMITH
CHIEF LEGAL OFFICER/PRIF SWYDDOG CYFREITHIOL
LEGAL, DEMOCRATIC SERVICES & BUSINESS INTELLIGENCE
GWASANAETHAU CYFREITHIOL, DEMOCRATAIDD A DEALLUSRWYDD BUSNES
CANOLFAN DDINESIG
SWANSEA
ABERTAWE
SA1 3SN



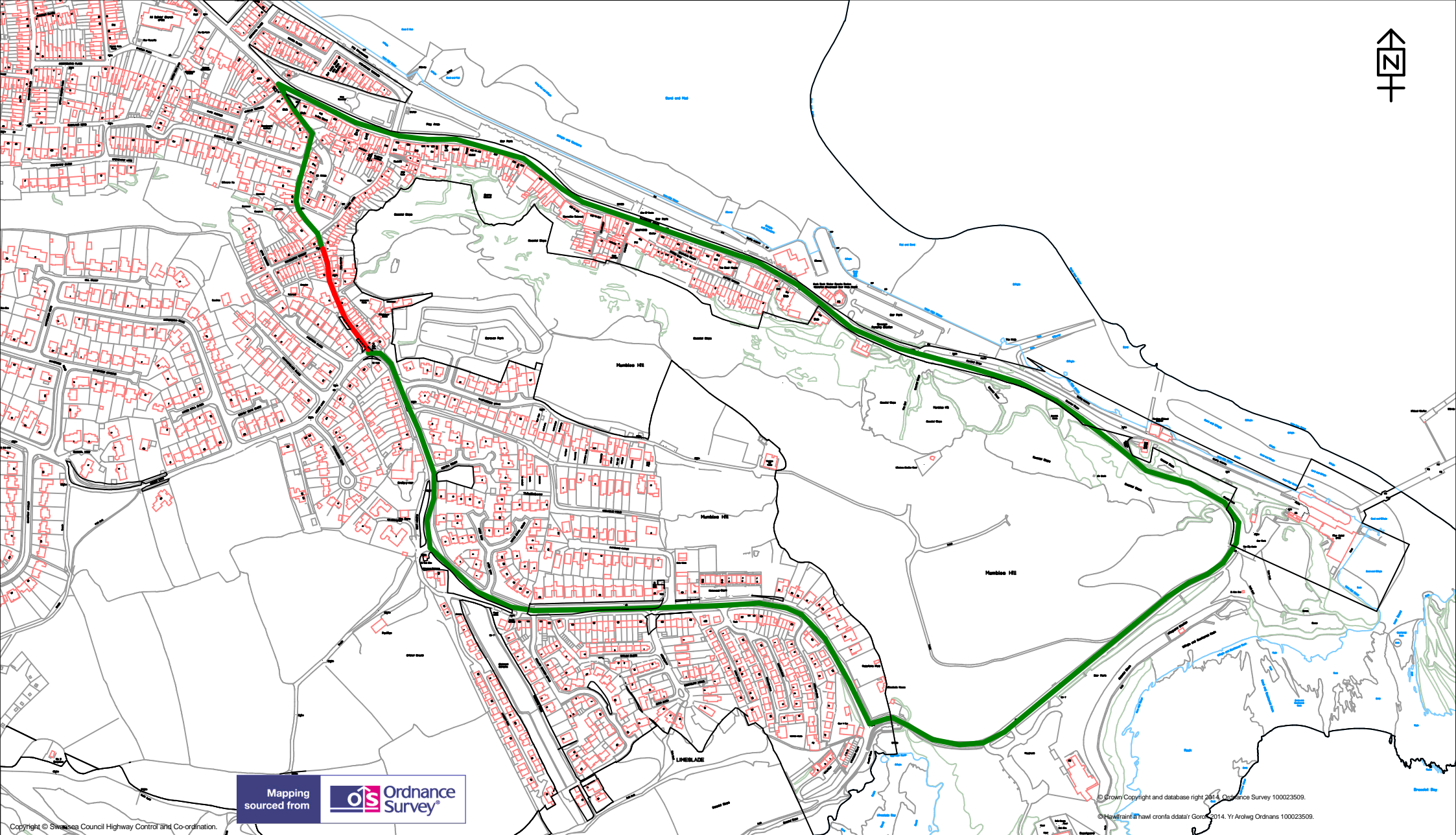

Mapping sourced from 

© Crown Copyright and database right 2014, Ordnance Survey 100023509.
© Hawtaint a hawl cronfa ddata'r Goron 2014, Yr Arolwg Ordnans 100023509.

City & County of Swansea
Cinas A Sir Abertawe





TEMPORARY TRAFFIC REGULATION ORDER

Highways and Transportation

Mr Phil Roberts,
Director
City and County of Swansea,
Station Road, Players Industrial Estate,
Clydach, Swansea, SA6 5BJ

THISTLEBOON ROAD, MUMBLES, SWANSEA.

KEY

- Temporary Road Closure 
- Alternative Route 

Scale
1:5848

| | |
|---------------------|--------------------|
| Drawn DH | Checked DH |
| Revision A | Date 11/01/2016 |
| Dwg/Ref.No. 1871 | |