

**THE COUNCIL OF THE CITY AND
COUNTY OF SWANSEA
CYNGOR DINAS A SIR ABERTAWE
TEMPORARY ROAD CLOSURES
QUARRR DRIVE(PART), SWANSEA.
NOTICE 2025**

NOTICE is hereby given that the Council of the City and County of Swansea in pursuance of its powers under the Road Traffic Regulation Act 1984 (as amended) intend to close the above-mentioned road. In order for BT to Install New Duct to the highway network it will be necessary to temporarily close the above roads to vehicular traffic.

**SCHEDULE
TEMPORARY ROAD CLOSURES
QUARRR DRIVE(PART), SWANSEA.**

**SCHEDULE - TEMPORARY ROAD CLOSURE
QUARR DRIVE(PART), SWANSEA**

Quarr Drive from its junction with B4603 Hebron Road in a northerly direction to its junction with Heol Dywyll, a distance of approximately 200 metres.

The alternative route for vehicular traffic will be via B4603 Hebron Road and Quarr Road, a distance of approximately 700 metres.

Similarly this route will only operate in the reverse direction.

Access for emergency vehicles and residents to be maintained at all times.

The closure will operate from **Monday 3rd November 2025** for 5 days (Or until the works are completed whichever is the sooner). It is anticipated the works will take 2 days to complete.

Dated this 31st October 2025

**L A MOORE
CHIEF LEGAL OFFICER / PRIF SWYDDOG CYFREITHIOL
LEGAL & DEMOCRATIC SERVICES
GWASANAETHAU CYFREITHIOL A DEMOCRATAIDD
CIVIC CENTRE
CANOLFAN DDINESIG
SWANSEA
ABERTAWE
SA1 3SN**

If you have any queries about this Notice please ring Dean Howard on 01792 841675

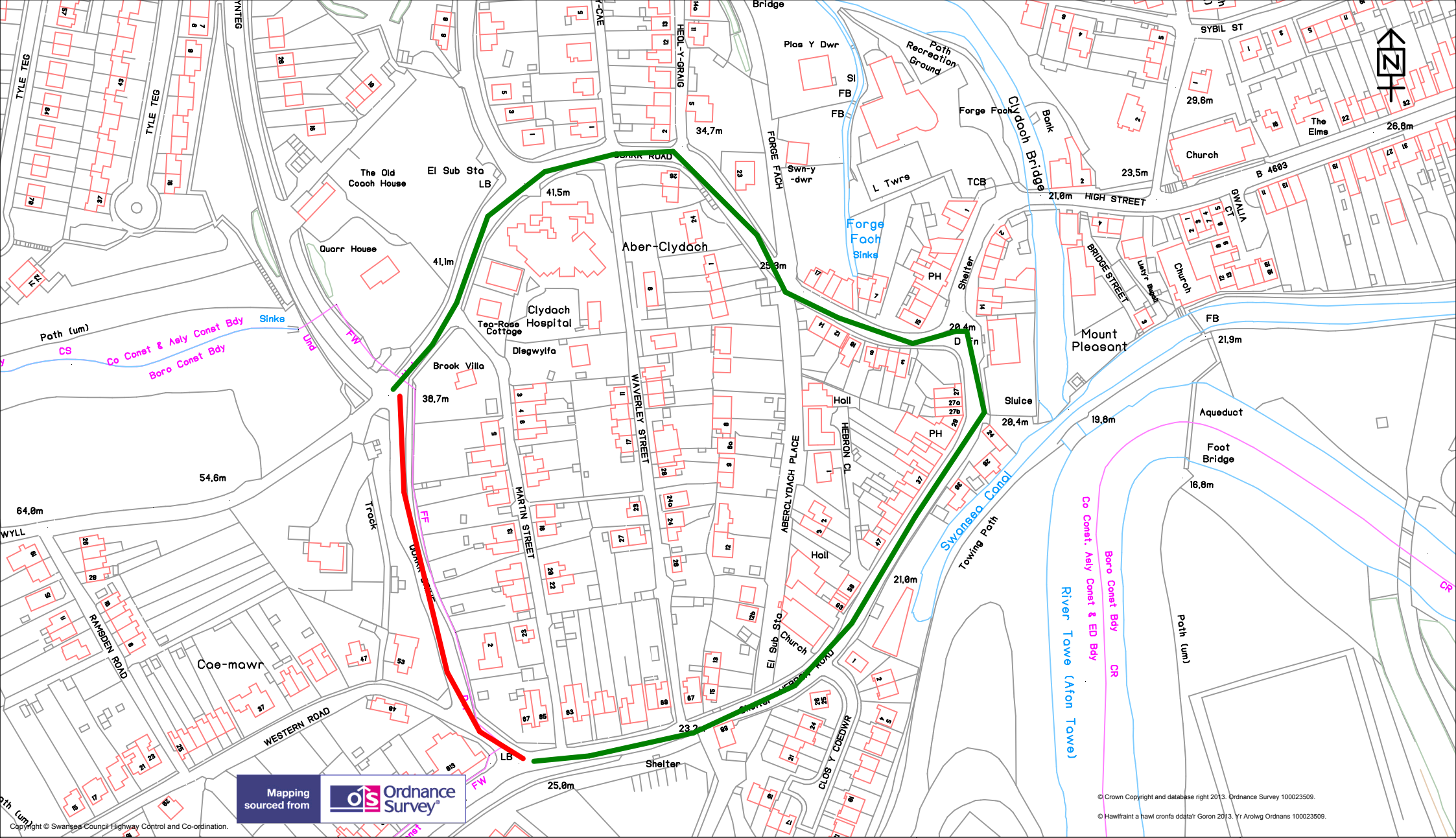

Mapping sourced from Ordnance Survey

© Crown Copyright and database right 2013. Ordnance Survey 100023509.
© Hawlfraint a hawl cronfa ddata'y Goron 2013. Yr Arolwg Ordnans 100023509.

City & County of Swansea
Cinas A Sir Abertawe



TEMPORARY TRAFFIC REGULATION ORDER

KEY

Temporary Road Closure 

Alternative Route 

| | | | |
|-------|----|---------|----|
| Scale | | 1:2254 | |
| Drawn | DH | Checked | DH |

Streetscene
Mr Carlton Humphrey, CEng, MICE,
Head of Streetscene
City and County of Swansea, Environment Department,
Station Road, Players Industrial Estate,
Clydach, Swansea, SA6 5BJ

QUARR DRIVE, CLYDACH, SWANSEA

| | | | |
|-------------|------|------|------------|
| Revision | A | Date | 20/05/2013 |
| Dwg/Ref.No. | 1525 | | |