

**THE COUNCIL OF THE CITY AND COUNTY OF SWANSEA  
CYNGOR DINAS A SIR ABERTAW  
TEMPORARY PROHIBITION OF PARKING  
B4489 HIGH STREET & PRINCE OF WALES ROAD (PART),  
CITY CENTRE, SWANSEA.  
NOTICE 2021**

**NOTICE** is hereby given that the Council of the City and County of Swansea in pursuance of its powers under the Road Traffic Regulation Act 1984 (as amended) has made an Order. In order for R&M Williams Limited to undertake Development Works on the Palace Theatre, it will be necessary to temporarily introduce parking prohibitions.

**SCHEDULE**

**SCHEDULE 1 - TEMPORARY PARKING PROHIBITION  
B4489 HIGH STREET (PART), CITY CENTRE**

B4489 High Street in a north-westerly direction from its junction with Matthew Street for a distance of approximately 55 metres.

**SCHEDULE 2 - TEMPORARY PARKING PROHIBITION  
PRINCE OF WALES ROAD (PART), CITY CENTRE**

Prince of Wales in a north-easterly direction from its junction with B4489 High Street for a distance of approximately 50 metres

The maximum duration of the order is 18 months and it is anticipated the work will take **60 weeks** to complete effective from **Wednesday 3rd November 2021**.

3<sup>rd</sup> November 2021

**TRACEY MEREDITH**

**CHIEF LEGAL OFFICER / PRIF SWYDDOG CYFREITHIOL**

**LEGAL, DEMOCRATIC SERVICES & BUSINESS INTELLIGENCE**

**GWASANAETHAU CYFREITHIOL, DEMOCRATAIDD A DEALLUSRWYDD**

**BUSNES**

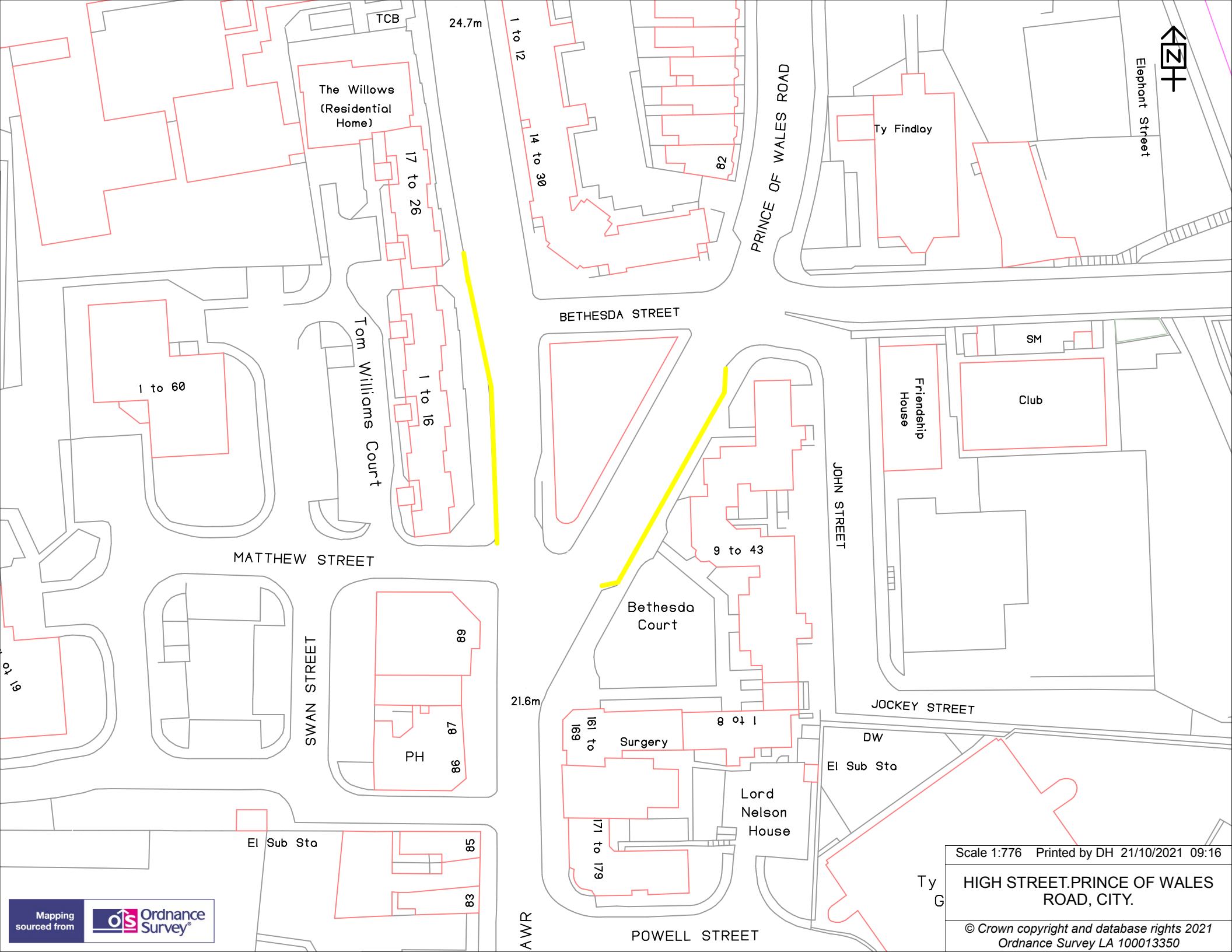

Elephant Street

Ty Findloy

PRINCE OF WALES ROAD

The Willows  
(Residential Home)

24.7m

1 to 12

14 to 30

82

17 to 26

BETHESDA STREET

Tom Williams Court

1 to 60

1 to 16

SM

Club

Friendship House

JOHN STREET

9 to 43

MATTHEW STREET

Bethesda Court

89

21.6m

87

86

PH

JOCKEY STREET

Surgery

161 to 169

8 to 1

DW

EI Sub Sto

Lord Nelson House

171 to 179

EI Sub Sto

85

83

Ty G

Scale 1:776 Printed by DH 21/10/2021 09:16

HIGH STREET, PRINCE OF WALES ROAD, CITY.

© Crown copyright and database rights 2021 Ordnance Survey LA 100013350

AWR

POWELL STREET